

DIRECT DRIVE PUMPS - PE-SERIES

Designed to operate continuously, direct drive pumps produce greater starting torque and more pressure than comparable magnetic drive pumps. Direct drive pumps are ideal for statuary fountains. Pre-filter is included to protect the pump.



FEATURES

- Hooded volute option for lower intake (fountain)
- Hooded volute indicated by "H"
- Compact design
- Rated for continuous duty

ORDERING INFORMATION

PE-Series	Item No.	Amps	Watts	Cord (ft)	Submerged Use	Discharge MNPT	Gallons Per Hour (GPH) @ Height				Shut-off (ft)
							1'	3'	5'	10'	
PE-1H-PW	566604	0.6	36	6'	✓	1/4"	170	140	100	-	7
PE-1F-PW	566608	0.6	36	15'	✓	1/4"	170	140	90	-	7
PE-2H-PW	566609	0.8	47	6'	✓	1/4"	300	255	205	70	12.2
PE-2F-PW	566611	0.8	47	15'	✓	1/4"	300	270	240	130	12.2
PE-25F-PW	566612	1.4	80	15'	✓	1/2"	475	440	395	205	13.4

DIMENSIONS

Dimensions (in)	A	B	C	D	E
PE-1H-PW	3.48	3.58	2.75	-	-
PE-1F-PW	4.9	3.6	2.8	0.9	1.89
PE-2H-PW	4.83	4.15	2.75	-	-
PE-2F-PW	5.6	4.2	2.8	0.9	2.38
PE-25F-PW	5.6	4.02	2.9	1.06	2.24

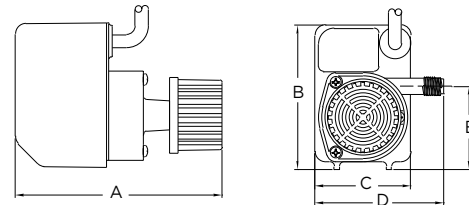

PE-25-PW, PE-2F-PW, PE-1F-PW

PERFORMANCE

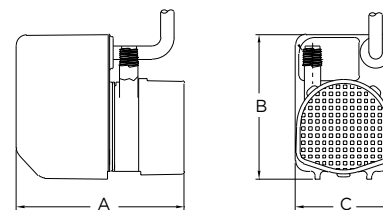
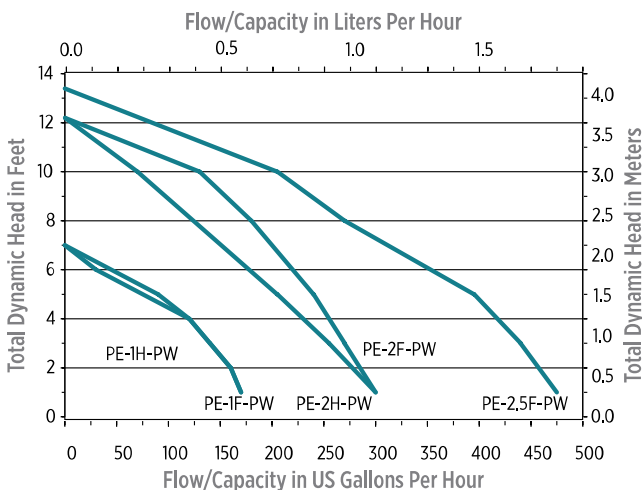

PE-2H-PW, PE-1H-PW